

**LEGEND**

- 1/2" ROD FOUND
- PK NAIL FOUND
- MAG NAIL FOUND
- 60D NAIL FOUND
- METAL FENCE
- WIRE FENCE
- ACCESS ESMT
- DRAINAGE ESMT
- ELECTRIC ESMT
- PUBLIC UTILITY ESMT
- WATER QUALITY ESMT
- RECORD INFORMATION
- WATER METER
- ELECTRIC TRANSFORMER ON PAD
- CABLE RISER
- ELECTRIC RISER
- TELEPHONE RISER
- MANHOLE
- ELECTRIC MANHOLE
- FIRE HYDRANT
- WELL HEAD
- GAS STUBBOUT
- WATER VALVE
- CONCRETE
- STONE
- ASPHALT

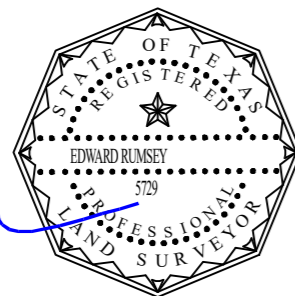

*[Handwritten Signature]*

TO THE LIEN HOLDER AND / OR OWNERS OF THE PREMISES SURVEYED AND TO:

**INDEPENDENCE TITLE COMPANY**

I DO HEREBY CERTIFY THAT THIS SURVEY WAS MADE ON THE GROUND UNDER MY SUPERVISION AND TO THE BEST OF MY KNOWLEDGE OF THE PROPERTY LEGALLY DESCRIBED HEREON AND THAT THERE ARE NO BOUNDARY LINE CONFLICTS, ENCROACHMENTS OVERLAPPING OF IMPROVEMENTS, OR ROADS IN PLACE, EXCEPT AS SHOWN HEREON, AND CERTIFIES ONLY TO THE LEGAL DESCRIPTION AND EASEMENTS SHOWN ON THE REFERENCED TITLE COMMITMENT. THIS SURVEY WAS PERFORMED WITHOUT THE BENEFIT OF AN ABSTRACT OF TITLE.

2,463.08 ACRES  
TRACT 1 - FIRST TRACT  
NATURE CONSERVANCY OF TEXAS, INC.  
(VOL. 12122, PG. 1031)

2,463.08 ACRES  
TRACT 1 - FIRST TRACT  
NATURE CONSERVANCY OF TEXAS, INC.  
(VOL. 12122, PG. 1031)

LOT 16  
BLOCK C  
BARTON CREEK SECTION H PHASE 4  
(DOC. 200700017)

LOT 12  
OPEN SPACE  
WQE & DE

**RESTRICTIONS**

SUBJECT TO RESTRICTIONS RECORDED IN VOL. 7593, PG. 699, VOL. 11324, PG. 707, VOL. 12945 PG. 335; DOC. NO. 2006033872, 2009016446, 2010101308, 2013088916, 2015135966, 2019114895; AND AS STATED ON PLAT RECORDED IN DOC. NO. 200300213.

SUBJECT TO RESERVATION OF EASEMENTS AND PROVISIONS REGARDING BUILDING SETBACK LINES IN VOL. 11324, PG. 707.

SUBJECT TO EASEMENTS RECORDED IN VOL. 4686, PG. 1921. (UNABLE TO PLOT)

SUBJECT TO EASEMENTS RECORDED IN VOL. 13204, PG. 66. (SHOWN)

SUBJECT TO EASEMENTS RECORDED IN VOL. 13204, PG. 79. (SHOWN)

SUBJECT TO EASEMENTS RECORDED IN DOC. NO. 2002041920. (DOES NOT AFFECT)

SUBJECT TO EASEMENTS RECORDED IN VOL. 13204, PG. 54. (DOES NOT AFFECT)

**LEGAL DESCRIPTION**

LOTS 13, 14 & 15, BLOCK A, BARTON CREEK SECTION H, PHASE 3, A SUBDIVISION IN TRAVIS COUNTY, TEXAS, ACCORDING TO THE MAP OR PLAT THEREOF, RECORDED IN DOC. NO. 200300213, OFFICIAL PUBLIC RECORDS, TRAVIS COUNTY, TEXAS.

LINE	BEARING	DISTANCE	LINE	BEARING	DISTANCE
L1	S 72°58'39" E	26.38'	L11	S 32°05'06" W	143.05'
(L1)	(S 72°58'39" E)	(26.38')	(L11)	(S 32°02'06" W)	(143.07')
L2	S 58°48'40" E	31.15'	L12	S 32°02'31" W	24.98'
(L2)	(S 58°48'40" E)	(31.15')	(L12)	(S 32°02'06" W)	(25.05')
L3	S 45°32'31" E	24.55'	L13	S 32°03'04" W	75.59'
(L3)	(S 45°03'59" E)	(24.44')	(L13)	(S 32°03'06" W)	(75.34')
L4	S 52°40'34" E	64.51'	L14	N 61°43'24" W	167.37'
(L4)	(S 52°44'43" E)	(64.65')	(L14)	(N 61°43'40" W)	(167.34')
L5	S 61°27'20" E	111.08'	L15	N 77°41'34" W	181.84'
(L5)	(S 61°27'20" E)	(111.08')	(L15)	(N 77°41'14" W)	(181.85')
L6	S 58°12'19" E	32.62'	L16	N 61°42'51" W	516.00'
(L6)	(S 58°10'54" E)	(32.66')	(L16)	(N 61°43'40" W)	(516.08')
L7	S 58°54'14" E	33.68'	L17	S 61°43'25" E	335.38'
(L7)	(S 58°53'26" E)	(33.52')	(L17)	(S 61°43'40" E)	(335.41')
L8	S 58°54'14" E	42.21'	L18	S 77°41'57" E	181.87'
(L8)	(S 58°53'26" E)	(42.37')	(L18)	(S 77°41'14" E)	(181.85')
L9	S 65°17'24" E	134.49'	L19	S 61°42'49" E	172.51'
(L9)	(S 65°17'24" E)	(134.49')	(L19)	(S 61°43'40" E)	(172.49')
L10	S 57°27'02" E	73.67'			
(L10)	(S 57°21'58" E)	(73.62')			

ADDRESS		F.I.R.M. MAP INFORMATION	
<b>DKH DEVELOPMENT L.P.</b> 4600 BARTON CREEK BLVD. AUSTIN, TRAVIS COUNTY, TEXAS		THIS PROPERTY DOES NOT LIE WITHIN THE 100 YEAR FLOOD-PLAIN, AND HAS A ZONE "X" RATING AS SHOWN ON THE FLOOD INSURANCE RATE MAPS F.I.R.M. MAP NO. 48453C0420J PANEL: 0420J DATED: 01/22/2020	
SURVEY DATE: JUNE 22, 2020 TITLE CO.: INDEPENDENCE TITLE CO. G.F. NO.: 2024278-ROL JOB NO.: A0605920		THIS CERTIFICATION IS FOR INSURANCE PURPOSES ONLY AND IS NOT A GUARANTEE THAT THIS PROPERTY WILL OR WILL NOT FLOOD. CONTACT YOUR LOCAL FLOOD PLAIN ADMINISTRATOR FOR THE CURRENT STATUS OF THIS TRACT.	
FIELD BY:	CHRIS ZOTTER	DATE:	06/20/2020
CALC. BY:	CHRIS ZOTTER	DATE:	06/21/2020
DRAWN BY:	DAVID BAK	DATE:	06/22/2020
UPDATE BY:	-	DATE:	-
RPLS CHECK:	EDWARD RUMSEY	DATE:	06/22/2020

**ALLSTAR**  
Land Surveying

9020 ANDERSON MILL RD  
AUSTIN, TEXAS 78729  
(512) 249-8149 PHONE  
(512) 331-5217 FAX  
TBPLS FIRM NO. 10135000

BEARING BASIS:  
BEARINGS ARE GRID NORTH BASED ON THE TEXAS COORDINATE SYSTEM CENTRAL TEXAS ZONE (4203) NAD83 HARN HORIZONTAL CONTROL.

